

Other switches

Foot switch

Foot switch for more efficient work

- A foot switch enables you to carry out work while seated, thus reducing the burden on your feet and creating more pleasant working conditions.
- Safe design with no exposed metal parts.



External dimensions (mm)

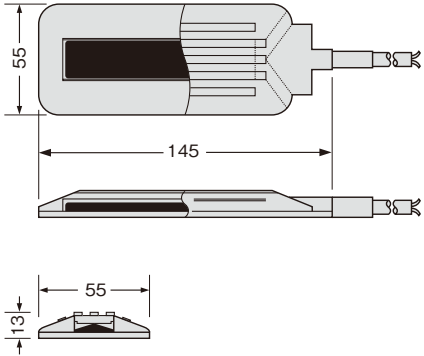

Specifications

Model No.	FS-111-B	FS-111-G
Color	Black	Gray
Rated voltage	5 – 24 V AC/DC	
Rated current	0.01 – 0.3 A (resistive load)	
Insulating resistance	100 MΩ min (250 VDC)	
Actuating force	Approx. 40 N	
Dielectric strength between electrodes	250 VDC for 1 minute	
Temperature range	0~50°C	
Weight	200g 1,600g including protective cover	
Lead wires	SVCTF (black), VCTF (gray) 0.75mm ² 2,000mm	
Covering material	Oil resistant rubber	
Model No. of protective cover	FS-P	

Quatro-switch

Goes ON when grasped.

- Uses 4 switch elements to detect grip strength.
- The 4 switch elements are normally connected in parallel (SBQ-P), but we can also manufacture this switch with the elements connected in series (SBQ-S).
- The length can be selected freely to a maximum of 3,000 mm.

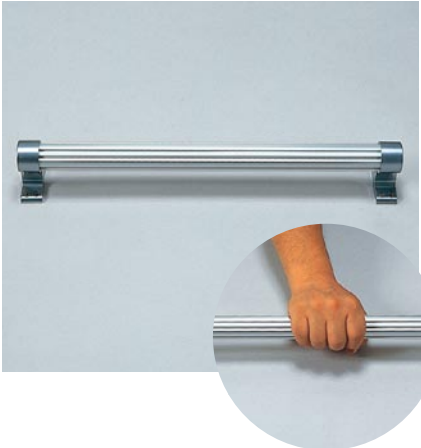

External dimensions (mm)

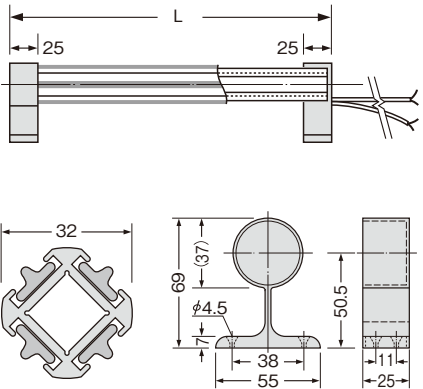

Specifications

Model No.	SBQ-P	SBQ-S	SBQ-PS
Color	White, red, pastel yellow (switch elements)		
Rated voltage	5 – 24 V AC/DC		
Rated current	0.01~0.3A(resistive load)		
Insulating resistance	100 MΩ min (250 VDC)		
Actuating force	Approx. 4 N (When switch elements are connected in parallel)		
Dielectric strength between electrodes	250 VDC for 1 minute		
Temperature range	0~50°C		
Lead wires	VFF (vinyl flat cords) 2-core × 2 0.5mm ² 500mm		

Click switch

You can fit this switch to any tool.

- This miniature switch produces a “clicking” sensation.
- Small and light for increased work efficiency.
- Responds immediately to the smallest movement of your fingertip, causing it to go ON or OFF.
- Can be easily installed on a variety of tools.
- Uses covering material that adapts to your finger with use.

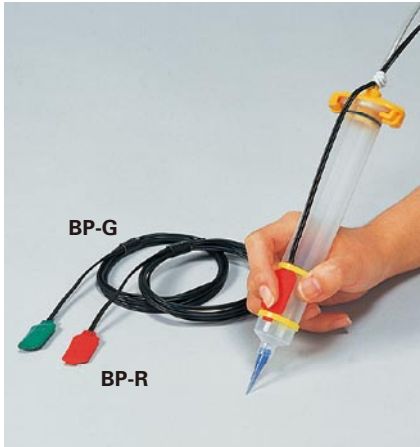

External dimensions (mm)

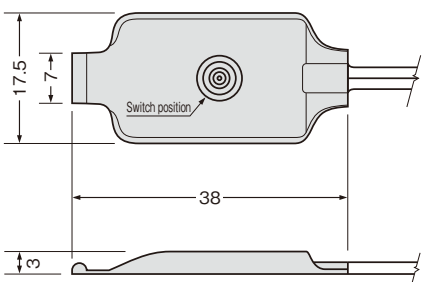

Specifications

Model No.	BP-G	BP-R
Color	Green	Red
Rated voltage	5 – 24 V AC/DC	
Rated current	0.01 – 0.1 A (resistive load)	
Insulating resistance	100 MΩ min (250 VDC)	
Dielectric strength between electrodes	250 VDC for 1 minute	
Temperature range	0~50°C	
Lead wires	VFF (vinyl flat cords) 0.3mm ² 1,500mm	
Covering material	PVC	
Mounting method	Two-sided adhesive tape, adhesive, rubber band, nylon band, cable tie, Velcro tape, others	

Call switch

Soft, with a gentle feel.

- Soft, with a texture that is gentle on your skin.
- Minute force is sufficient to turn ON the switch.
- Sealed construction prevents ingress of water and dust.



External dimensions (mm)

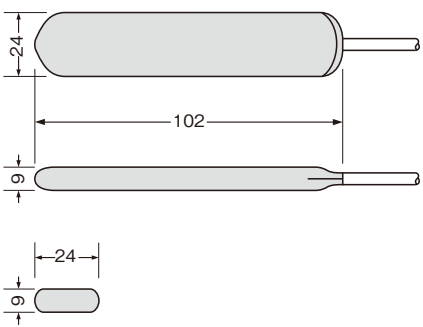

Specifications

Model No.	CS-100-W
Color	White
Rated voltage	5 – 24 V AC/DC
Rated current	0.01 – 0.3 A (resistive load)
Insulating resistance	100 MΩ min (250 VDC)
Dielectric strength between electrodes	250 VDC for 1 minute
Temperature range	0~50°C
Water resistance	JIS C 0920:2003 Protection class 7
Lead wires	SVCTF (Containing Tetron thread) 2-core 0.2mm ² 2,000mm white
Covering material	PVC